









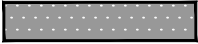

10/27/21

LEGEND:

-  PROPERTY LINE
-  EXISTING CONTOUR
-  EXISTING JETTY/PIER
-  EXISTING FLOATING DOCKS
-  PROPOSED CONCRETE FLOATING DOCKS
-  PROPOSED CONCRETE FLOATING WAVE ATTENUATOR DOCKS
-  PROPOSED TIMBER FLOATING DOCKS
-  EXISTING JETTY/PIER
-  PROPOSED CONTOUR
-  PROPOSED PILE
-  PHOTOGRAPH LOCATION
(SEE PHOTO KEY, ATTACHMENT 3)

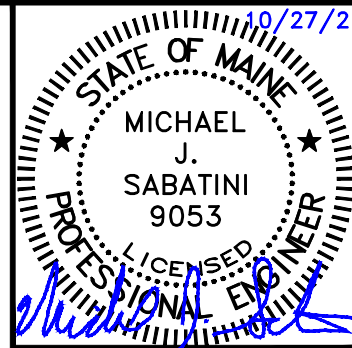

PLAN NOTES:

1. THESE PLANS ARE FOR NRPA PERMITTING ASSOCIATED WITH EXPANSION OF SAFE HARBOR-ROCKLAND MARINA IN ROCKLAND, MAINE.
2. PROPERTY LINES SHOWN ARE TAKEN FROM THE PLAN TITLED "STANDARD BOUNDARY SURVEY, BRACEBRIDGE CORPORATION, FISHER ENGINEERING PROPERTIES, WATER & OCEAN STREETS" DATED APRIL 19, 2000 AND PREPARED BY COFFIN ENGINEERING AND SURVEYING AND A PLAN TITLED CONVEYANCE PLAN - BAYVIEW MANAGEMENT, DATED NOVEMBER 30, 2020, PREPARED BY GARTLEY & DORSKY.
3. ELEVATIONS SHOWN ARE REFERENCED TO MEAN LOW WATER (MLW) AND ARE TAKEN FROM THE PLAN TITLED "ROCKLAND HARBOR PARK, LLC, TRIDENT YACHT BASIN", DATED DECEMBER 17, 2009 AND PREPARED BY GARTLEY AND DORSKY. ADDITIONAL BATHYMETRIC DATA CONDUCTED BY ECO-ANALYSTS IN NOVEMBER OF 2017 HAS BEEN INCORPORATED.
4. PROPOSED FLOATS, PILINGS, PIER, AND DREDGING ARE DESIGNED BY APPLIED TECHNOLOGY MANAGEMENT, INC.



LANDMARK CORPORATION

SURVEYORS & ENGINEERS

135 Rockland Street ROCKPORT, MAINE 04856 PHONE: (207) 236-6757 WWW.LANDMARKMAINE.COM

SH ROCKLAND - MARINA EXPANSION NRPA PERMIT APPLICATION ROCKLAND, MAINE

SCALE: N/A

OCTOBER 2021

NOTES:

1. CONTOURS ARE IN FEET AND REFERENCE MEAN LOW WATER (MLW).
2. CONTOURS BASED ON DEC. 2009 SURVEY BY GARTLEY AND DASKY AND UPDATED SURVEY NOV. 2017 SURVEY BY ECO-ANALYSTS.

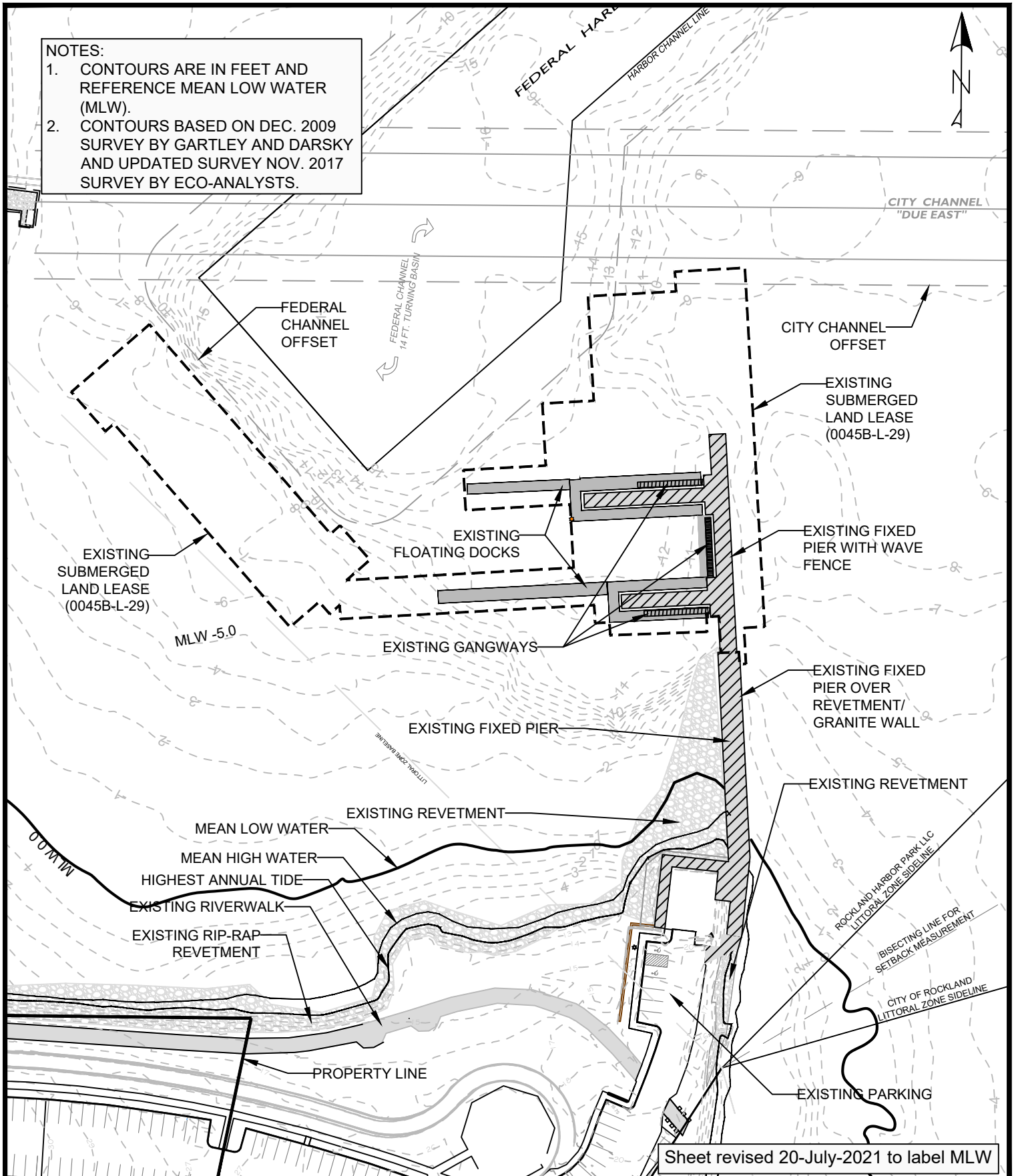

LANDMARK CORPORATION

SURVEYORS & ENGINEERS

135 Rockland Street Rockport, Maine 04856 Phone: (207) 236-6757 www.landmarkmaine.com

**SH ROCKLAND - NRPA APPLICATION
EXISTING CONDITIONS PLAN
ROCKLAND, MAINE**

SCALE: 1"=100'

OCTOBER 2021

NOTES:

1. CONTOURS ARE IN FEET AND REFERENCE MEAN LOW WATER (MLW).
2. CONTOURS BASED ON DEC. 2009 SURVEY BY GARTLEY AND DASKY AND UPDATED SURVEY NOV. 2017 SURVEY BY ECO-ANALYSTS.

SLIP LEGEND	
(40)	DOUBLE LOADED
30	SINGLE LOADED

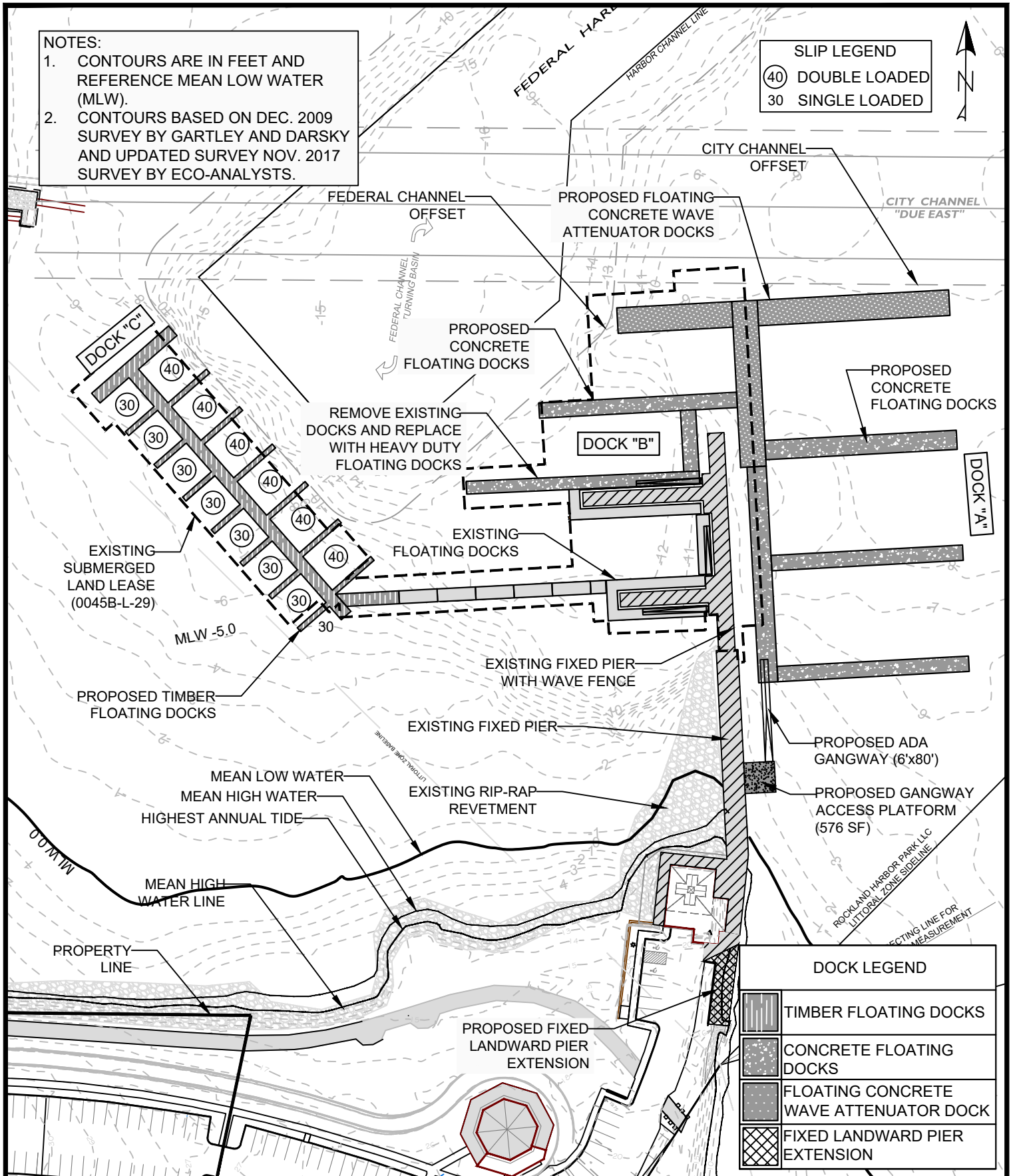
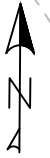

DOCK LEGEND	
	TIMBER FLOATING DOCKS
	CONCRETE FLOATING DOCKS
	FLOATING CONCRETE WAVE ATTENUATOR DOCK
	FIXED LANDWARD PIER EXTENSION



LANDMARK CORPORATION

SURVEYORS & ENGINEERS

135 Rockland STREET ROCKPORT, MAINE 04856 PHONE: (207) 236-6757 WWW.LANDMARKMAINE.COM

**SH ROCKLAND - NRPA APPLICATION
PROPOSED IMPROVEMENTS OVERVIEW
ROCKLAND, MAINE**

SCALE: 1"=100'

OCTOBER 2021

NOTE: COORDINATES
REFERENCE NAD83,
MAINE, EAST ZONE.

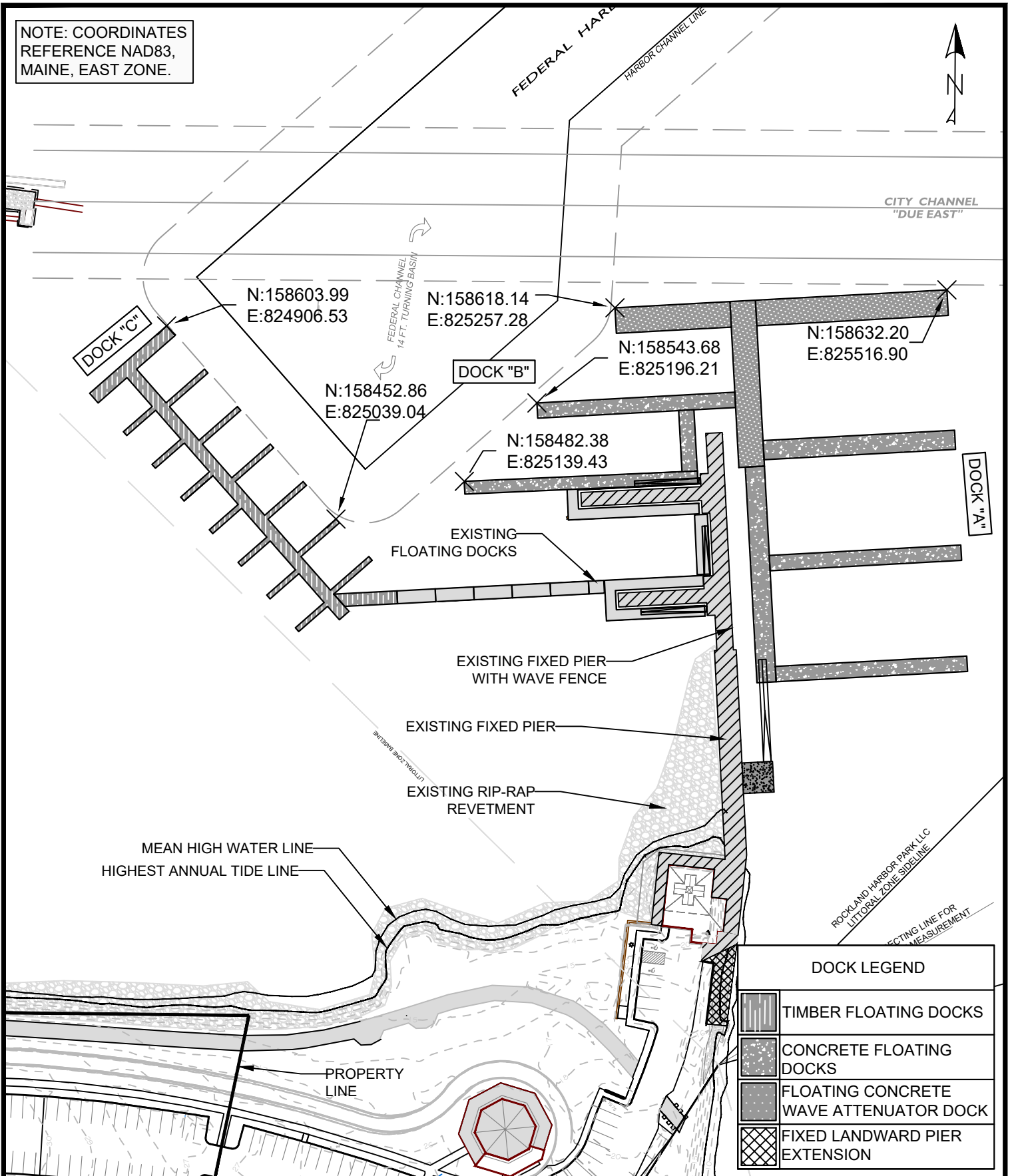
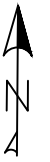

DOCK LEGEND

	TIMBER FLOATING DOCKS
	CONCRETE FLOATING DOCKS
	FLOATING CONCRETE WAVE ATTENUATOR DOCK
	FIXED LANDWARD PIER EXTENSION



LANDMARK CORPORATION

SURVEYORS & ENGINEERS

135 Rockland Street ROCKPORT, MAINE 04856 PHONE: (207) 236-6757 WWW.LANDMARKMAINE.COM

**SH ROCKLAND - NRPA APPLICATION
PROPOSED DOCK COORDINATES
ROCKLAND, MAINE**

SCALE: 1"=100'

OCTOBER 2021

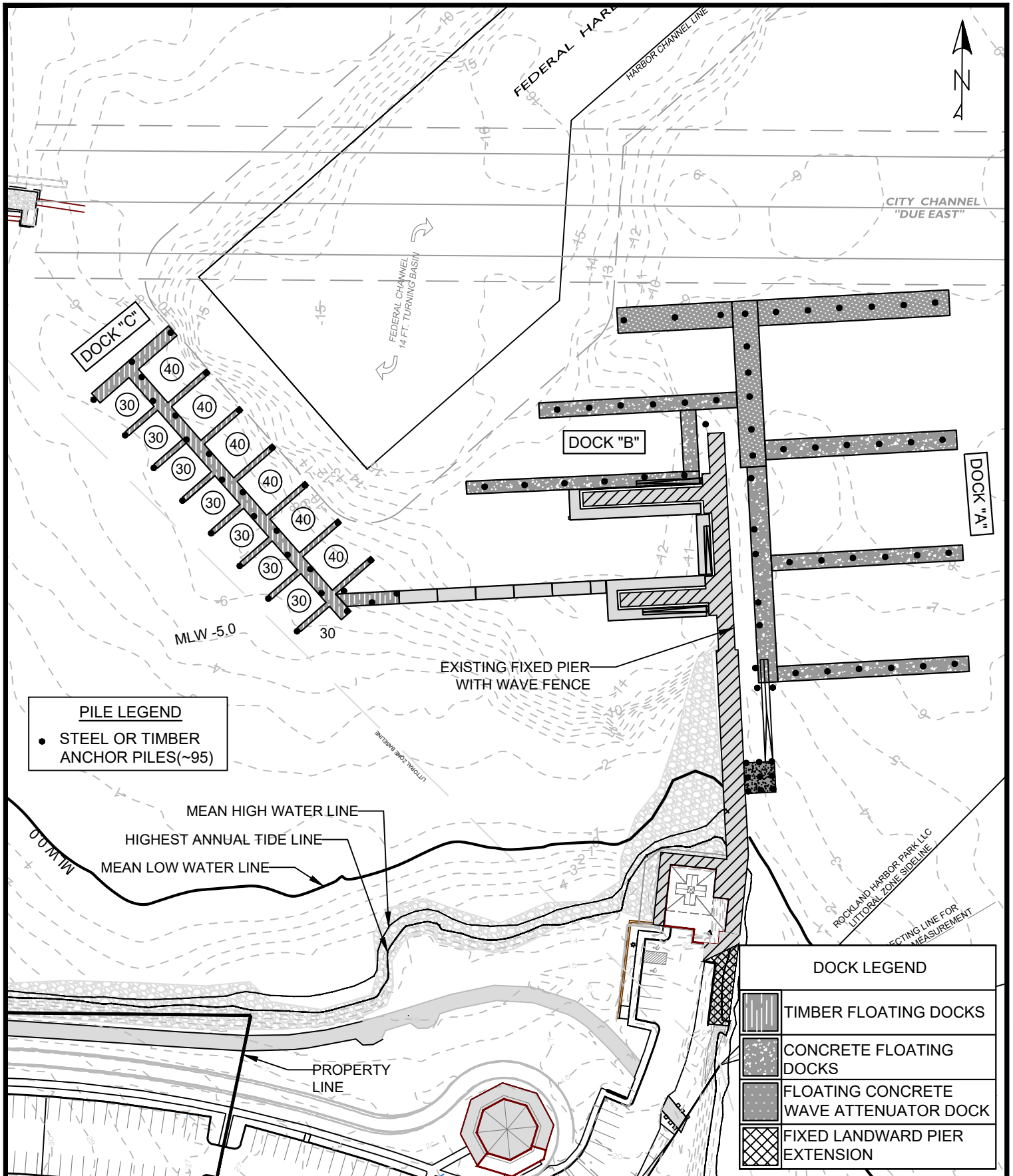

PILE LEGEND
 ● STEEL OR TIMBER ANCHOR PILES (~95)

DOCK LEGEND

	TIMBER FLOATING DOCKS
	CONCRETE FLOATING DOCKS
	FLOATING CONCRETE WAVE ATTENUATOR DOCK
	FIXED LANDWARD PIER EXTENSION



LANDMARK CORPORATION

SURVEYORS & ENGINEERS

135 Rockland Street Rockport, Maine 04856 Phone: (207) 236-6757 www.landmarkmaine.com

**SH ROCKLAND - NRPA APPLICATION
 APPROXIMATE ANCHOR PILE PLAN
 ROCKLAND, MAINE**

SCALE: 1"=100'

OCTOBER 2021

FEDERAL CHANNEL
OFFSET

CITY CHANNEL
"DUE EAST"

PROPOSED FLOATING
CONCRETE WAVE
ATTENUATOR DOCKS

CITY CHANNEL
OFFSET

DOCK "A" T-HEAD

260'

20'

150'

(B)

90'

90'

51'

155'

PROPOSED
CONCRETE
FLOATING DOCKS

15'

47'

170'

12'

48'

150'

DOCK "A"

75'

EXISTING GANGWAY
(TO REMAIN)

12'

150'

75'

EXISTING GANGWAY
(TO REMAIN)

(A)

12'

150'

PROPOSED ADA
COMPLIANT GANGWAY
(6'x80')

15'

24'

PROPOSED GANGWAY
ACCESS PLATFORM
(576 SF)

24'

(E)

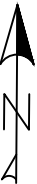

LEGEND

	TIMBER FLOATING DOCKS
	CONCRETE FLOATING DOCKS
	FLOATING CONCRETE WAVE ATTENUATOR DOCK



LANDMARK CORPORATION

SURVEYORS & ENGINEERS



135 Rockland STREET ROCKPORT, MAINE 04856 PHONE: (207) 236-6757 WWW.LANDMARKMAINE.COM

SH ROCKLAND - NRPA APPLICATION
DOCK A DIMENSION PLAN
ROCKLAND, MAINE

SCALE: 1"=60'

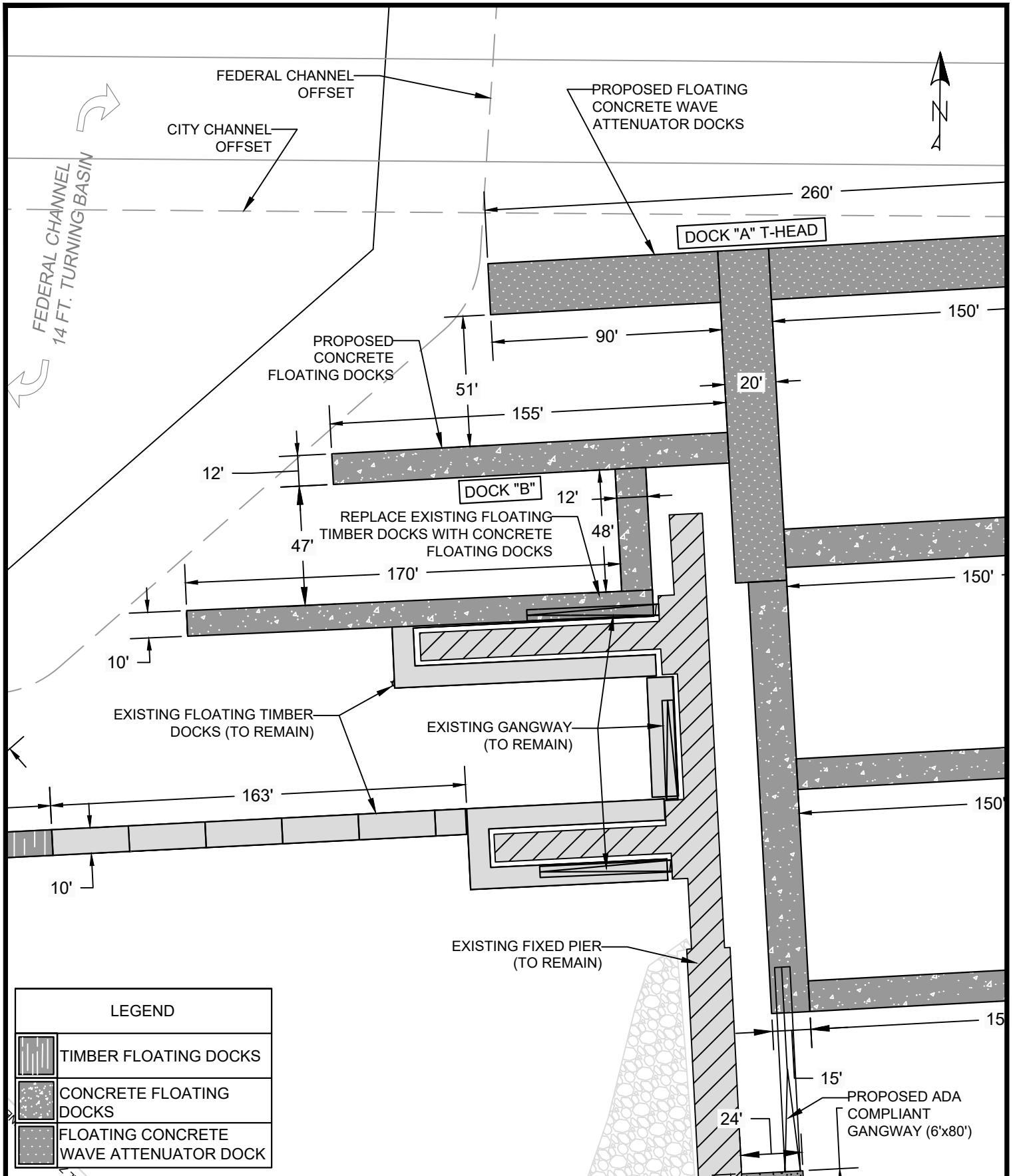
OCTOBER 2021

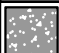

LEGEND	
	TIMBER FLOATING DOCKS
	CONCRETE FLOATING DOCKS
	FLOATING CONCRETE WAVE ATTENUATOR DOCK





135 Rockland STREET ROCKPORT, MAINE 04856 PHONE: (207) 236-6757 WWW.LANDMARKMAINE.COM

SH ROCKLAND - NRPA APPLICATION
DOCK B DIMENSION PLAN
ROCKLAND, MAINE

SCALE: 1"=60'

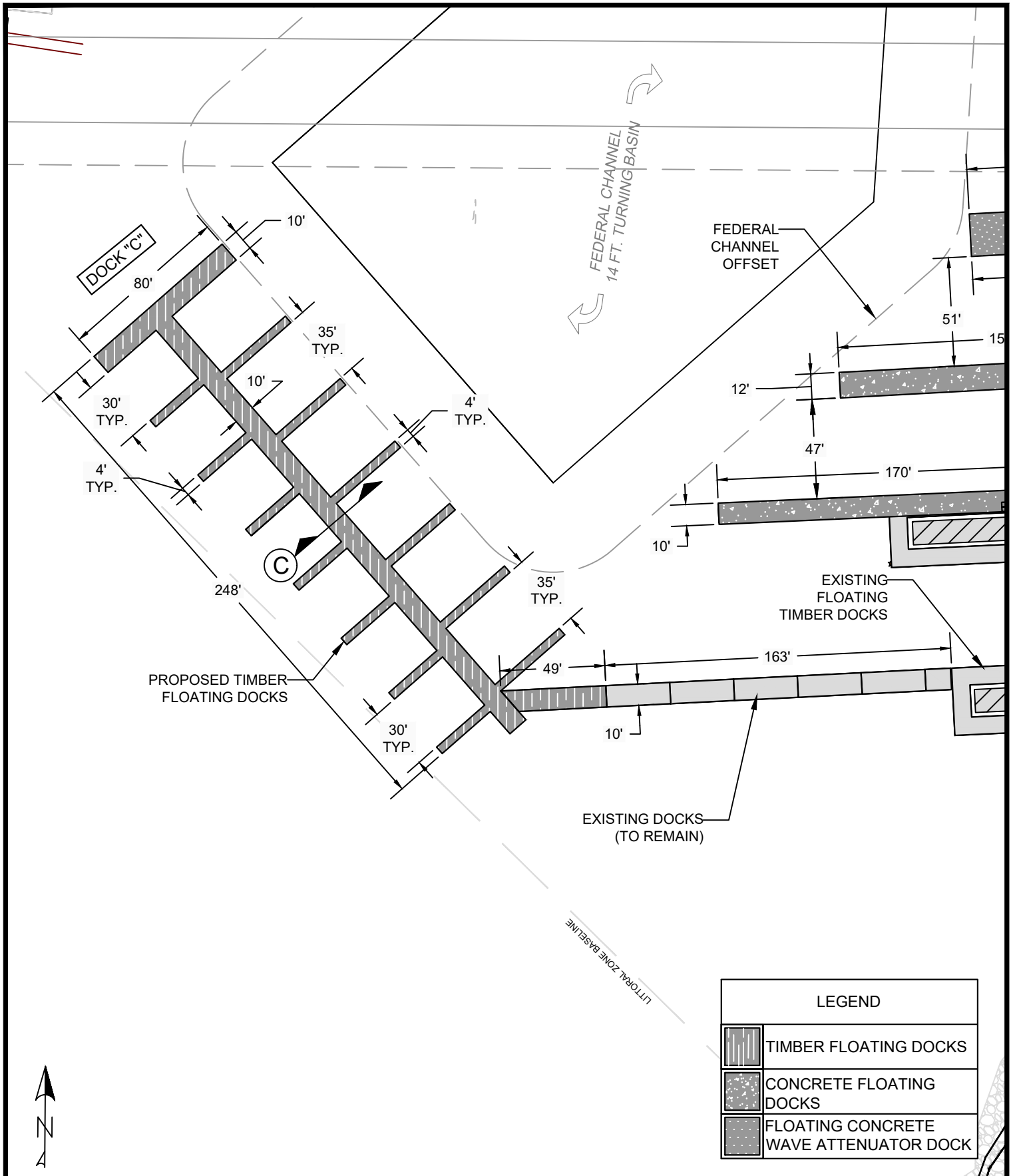
OCTOBER 2021

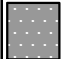

LEGEND	
	TIMBER FLOATING DOCKS
	CONCRETE FLOATING DOCKS
	FLOATING CONCRETE WAVE ATTENUATOR DOCK



LANDMARK CORPORATION

SURVEYORS & ENGINEERS

135 Rockland Street Rockport, Maine 04856 Phone: (207) 236-6757 www.landmarkmaine.com

**SH ROCKLAND - NRPA APPLICATION
DOCK C DIMENSION PLAN
ROCKLAND, MAINE**

SCALE: 1"=60'

OCTOBER 2021

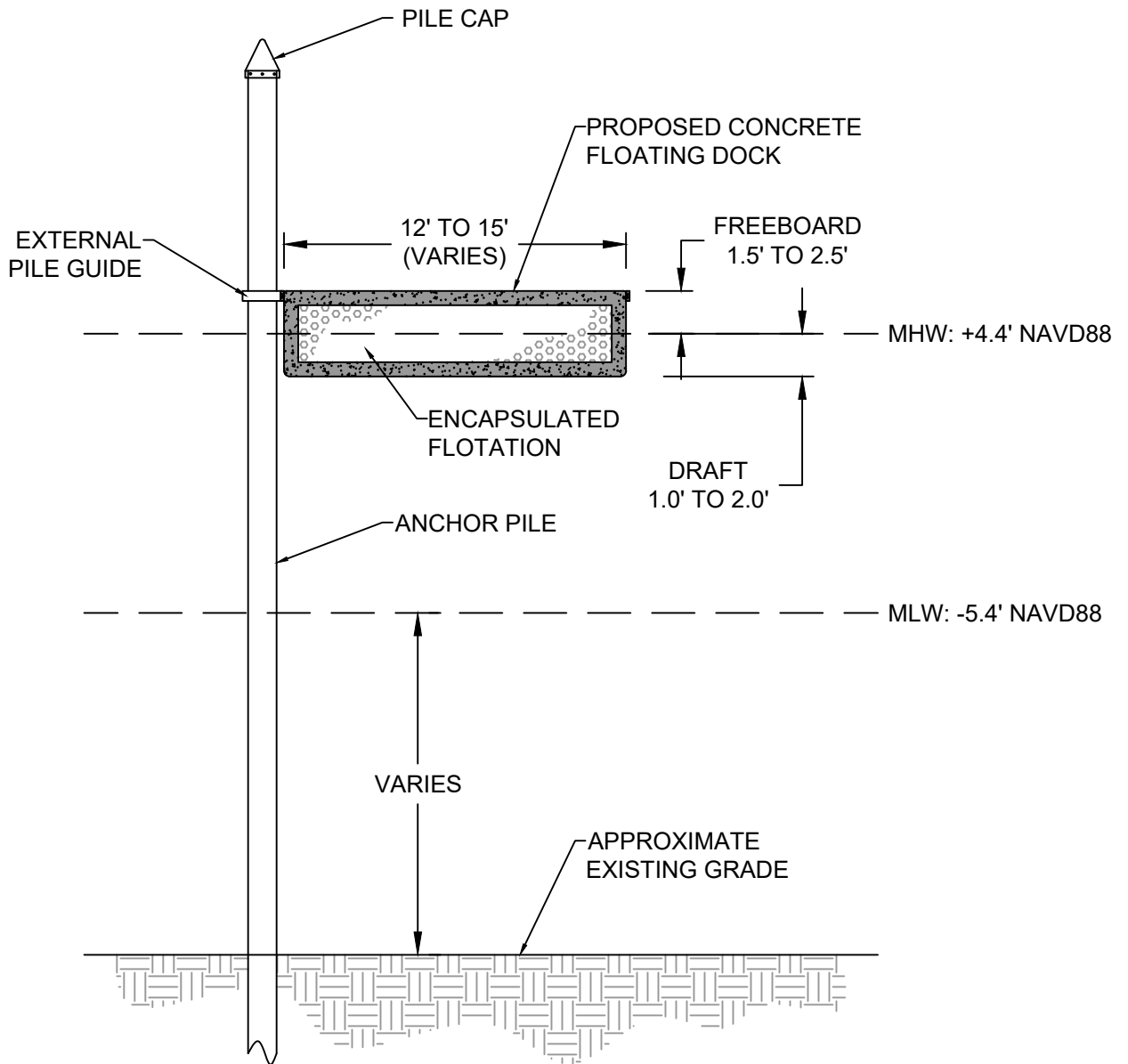

(A) TYPICAL CONCRETE FLOATING DOCK SECTION



LANDMARK CORPORATION

SURVEYORS & ENGINEERS

135 Rockland Street Rockport, Maine 04856 Phone: (207) 236-6757 www.landmarkmaine.com

SH ROCKLAND - NRPA APPLICATION
TYPICAL CONCRETE FLOATING DOCK DETAILS
ROCKLAND, MAINE

SCALE: 1"=6'

OCTOBER 2021

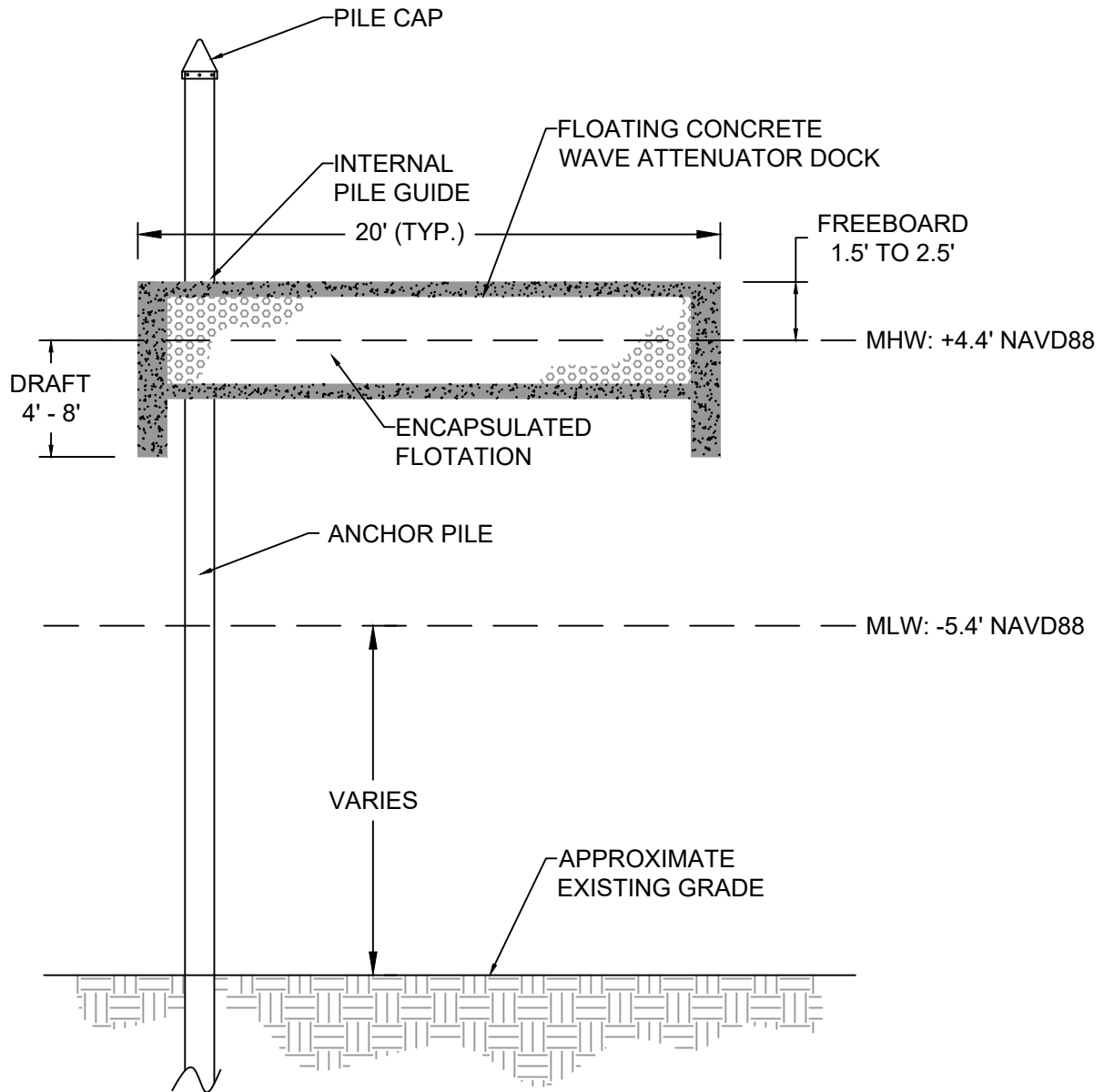

(B) TYPICAL FLOATING CONCRETE WAVE ATTENUATOR DOCK SECTION



LANDMARK CORPORATION

SURVEYORS & ENGINEERS

135 Rockland Street Rockport, Maine 04856 Phone: (207) 236-6757 www.landmarkmaine.com

SH ROCKLAND - NRPA APPLICATION
TYPICAL FLOATING CONCRETE WAVE ATTENUATOR
ROCKLAND, MAINE

SCALE: 1"=6'

OCTOBER 2021

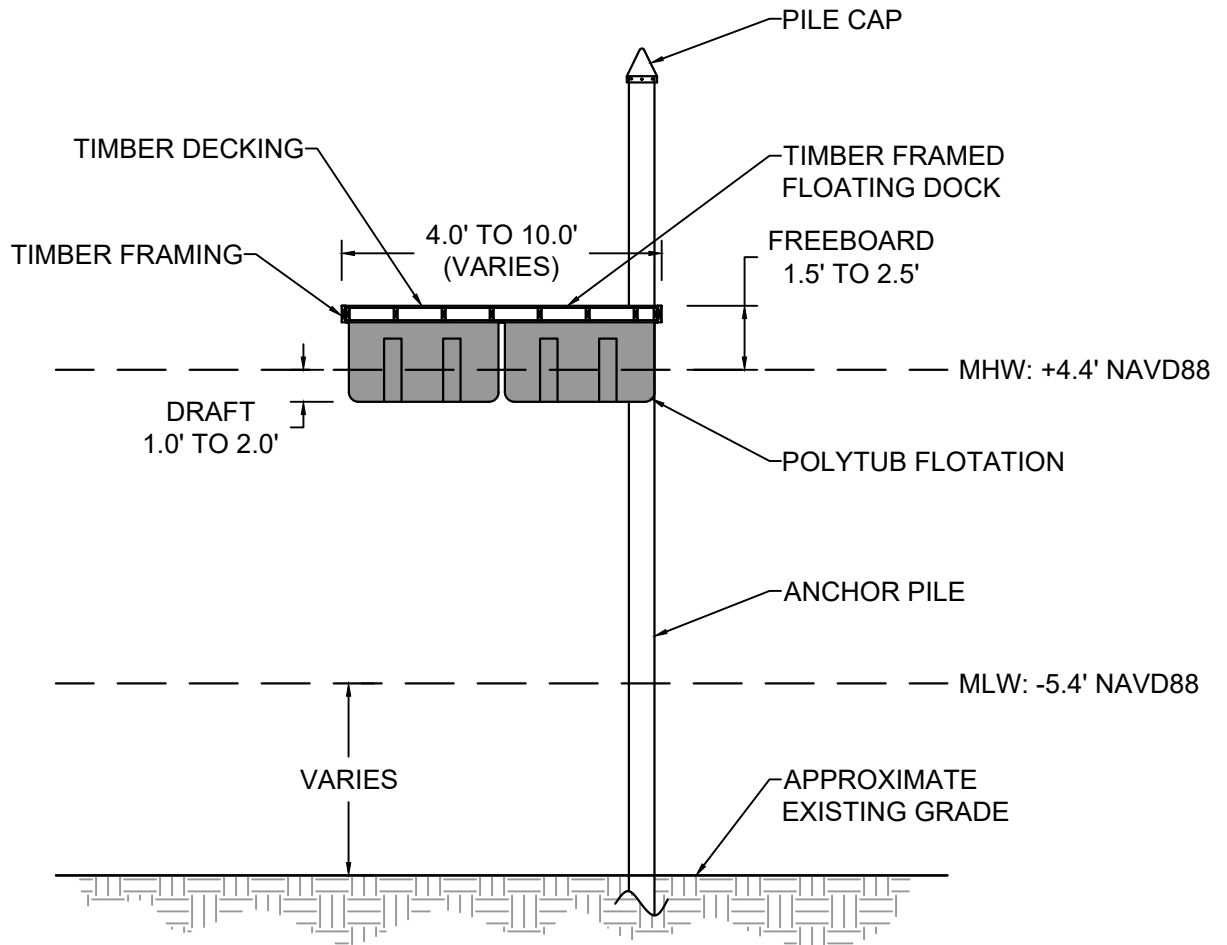

© TYPICAL TIMBER FLOATING DOCK SECTION

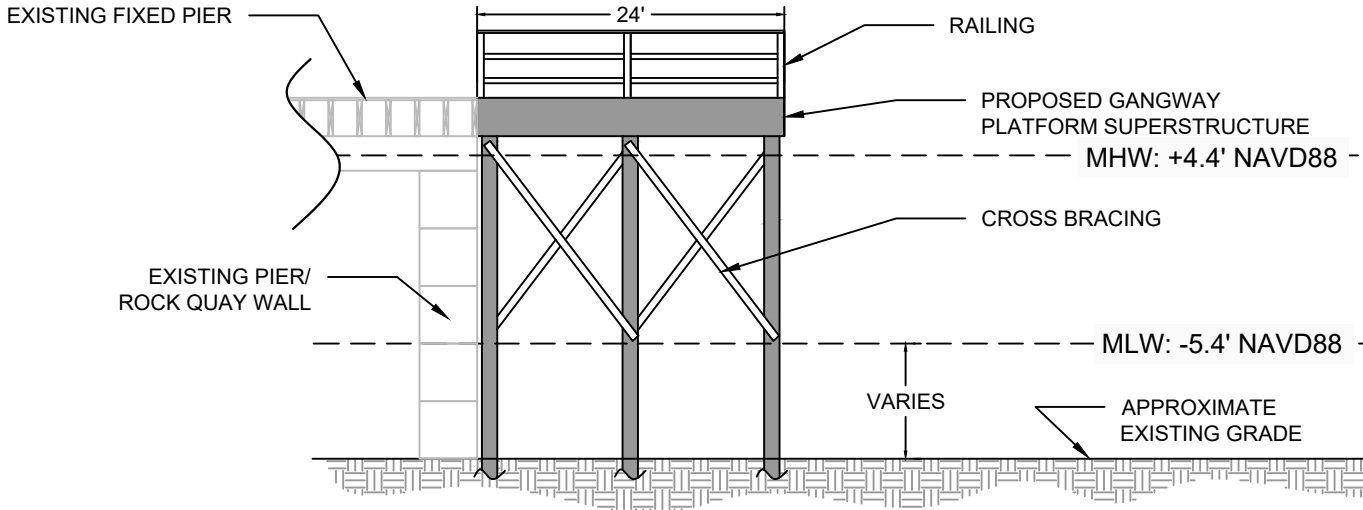

D TYPICAL GANGWAY ACCESS PLATFORM SECTION

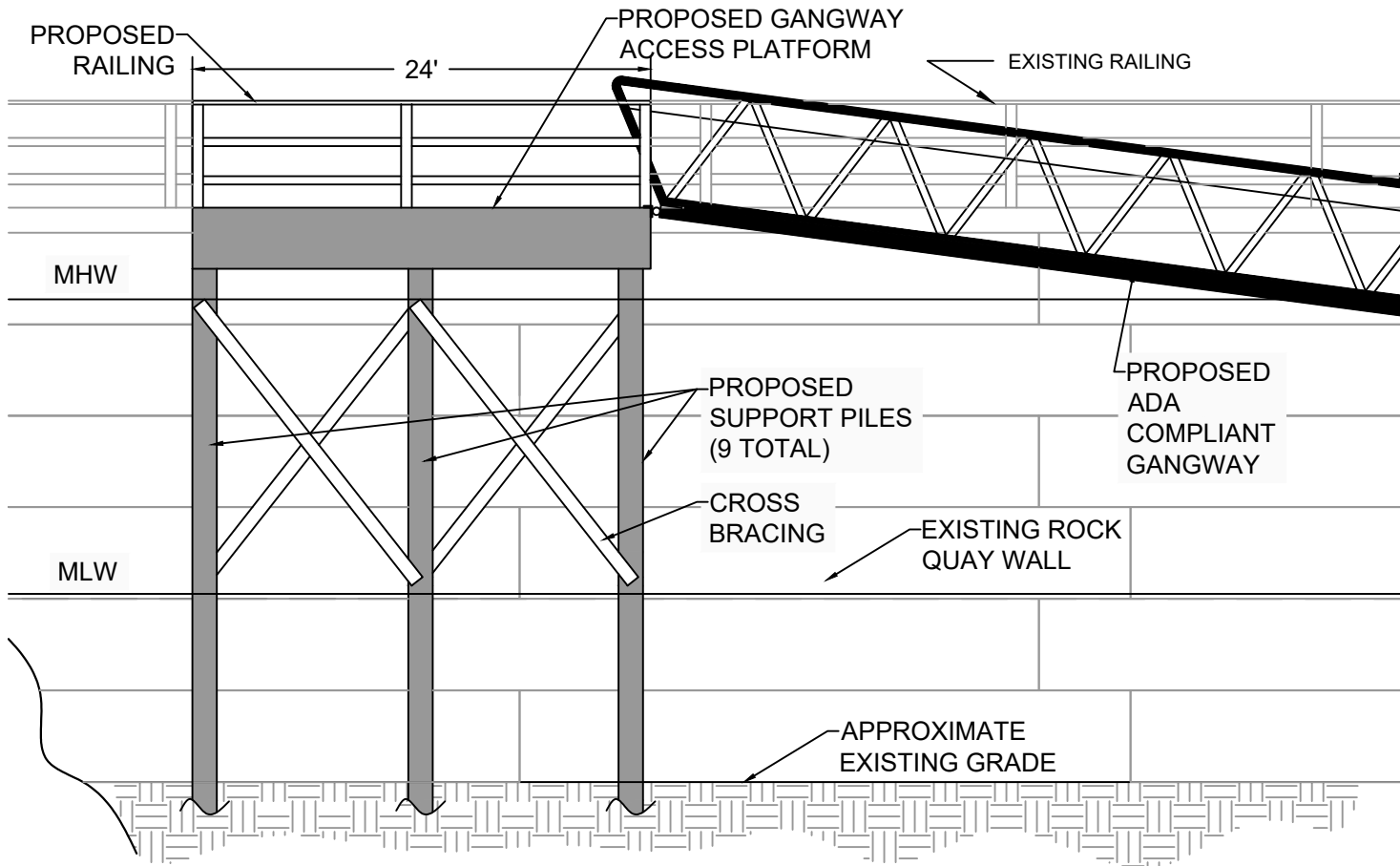

E TYPICAL GANGWAY ACCESS PLATFORM SECTION



LANDMARK CORPORATION

SURVEYORS & ENGINEERS

135 Rockland Street Rockport, Maine 04856 Phone: (207) 236-6757 www.landmarkmaine.com

SH ROCKLAND - NRPA APPLICATION
TYPICAL GANGWAY ACCESS PLATFORM DETAILS
ROCKLAND, MAINE

SCALE: NTS

OCTOBER 2021

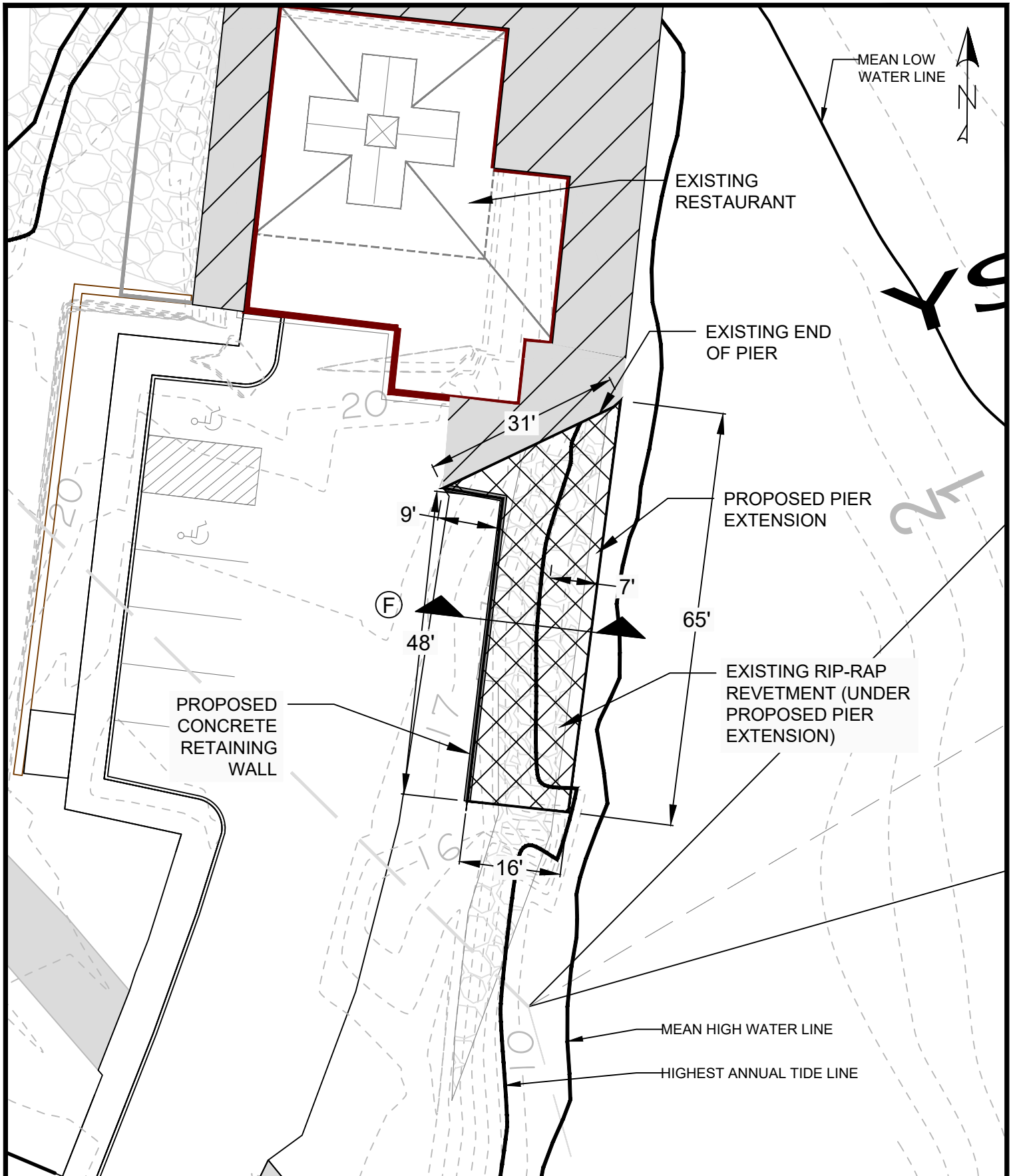

LANDMARK CORPORATION

SURVEYORS & ENGINEERS

135 Rockland Street Rockport, Maine 04856 Phone: (207) 236-6757 www.landmarkmaine.com

**SH ROCKLAND - NRPA APPLICATION
SHOREWARD PIER EXTENSION LAYOUT
ROCKLAND, MAINE**

SCALE: 1"=20'

OCTOBER 2021

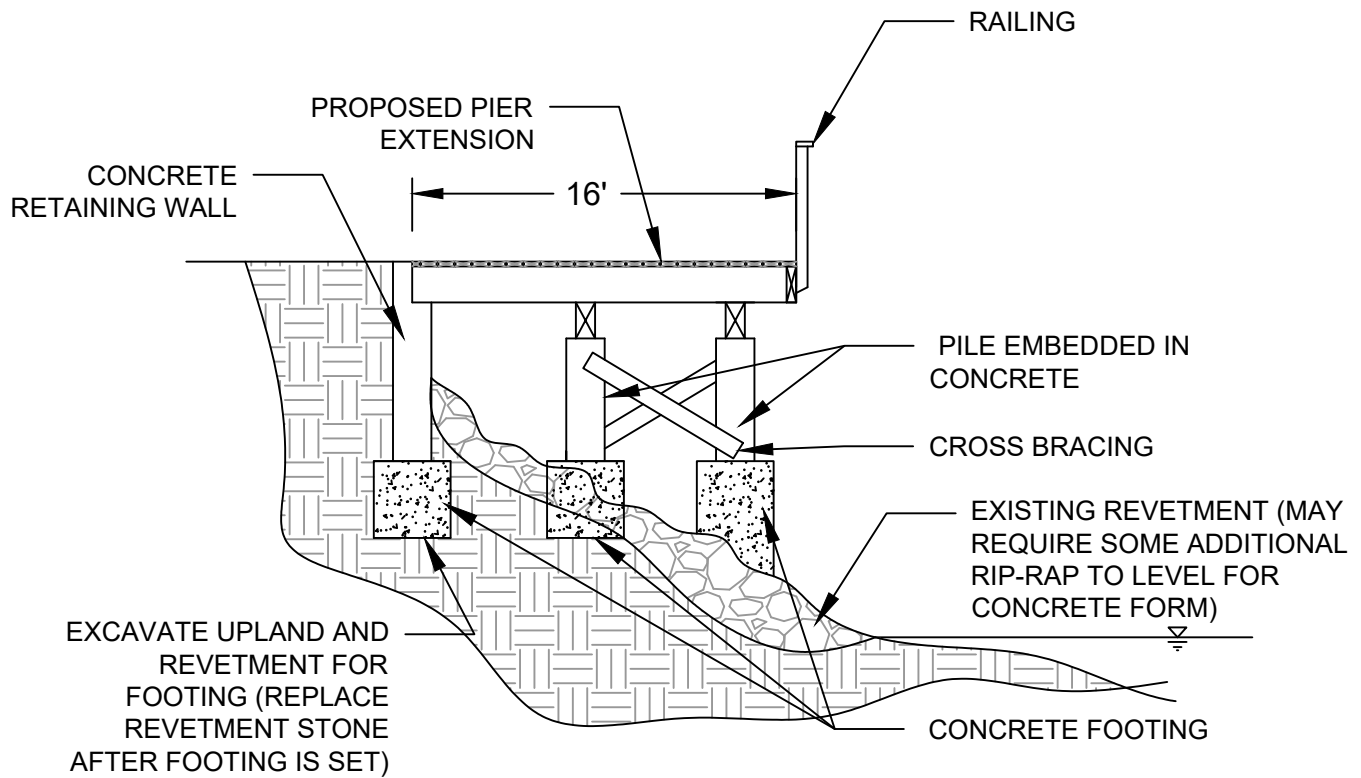

(F) TYPICAL LANDWARD FIXED PIER
EXTENSION SECTION



LANDMARK CORPORATION

SURVEYORS & ENGINEERS

135 Rockland Street Rockport, Maine 04856 Phone: (207) 236-6757 www.LandmarkMaine.com

SH ROCKLAND - NRPA APPLICATION
TYPICAL LANDWARD PIER EXTENSION SECTION
ROCKLAND, MAINE

SCALE: NTS

OCTOBER 2021

FOR PERMITTING PURPOSES ONLY
 "NOT FOR CONSTRUCTION"

NOTES:

1. CONTOURS ARE IN FEET AND REFERENCE MEAN LOW WATER (MLW).
2. CONTOURS BASED ON DEC. 2009 SURVEY BY GARTLEY AND DASKY AND UPDATED SURVEY NOV. 2017 SURVEY BY ECO-ANALYSTS.

DREDGE DEPTH LEGEND

	-6' MLW: ~2.0 ACRES
	-8' MLW: ~0.5 ACRES
	-10' MLW: ~0.3 ACRES
	-13' MLW: ~2.2 ACRES

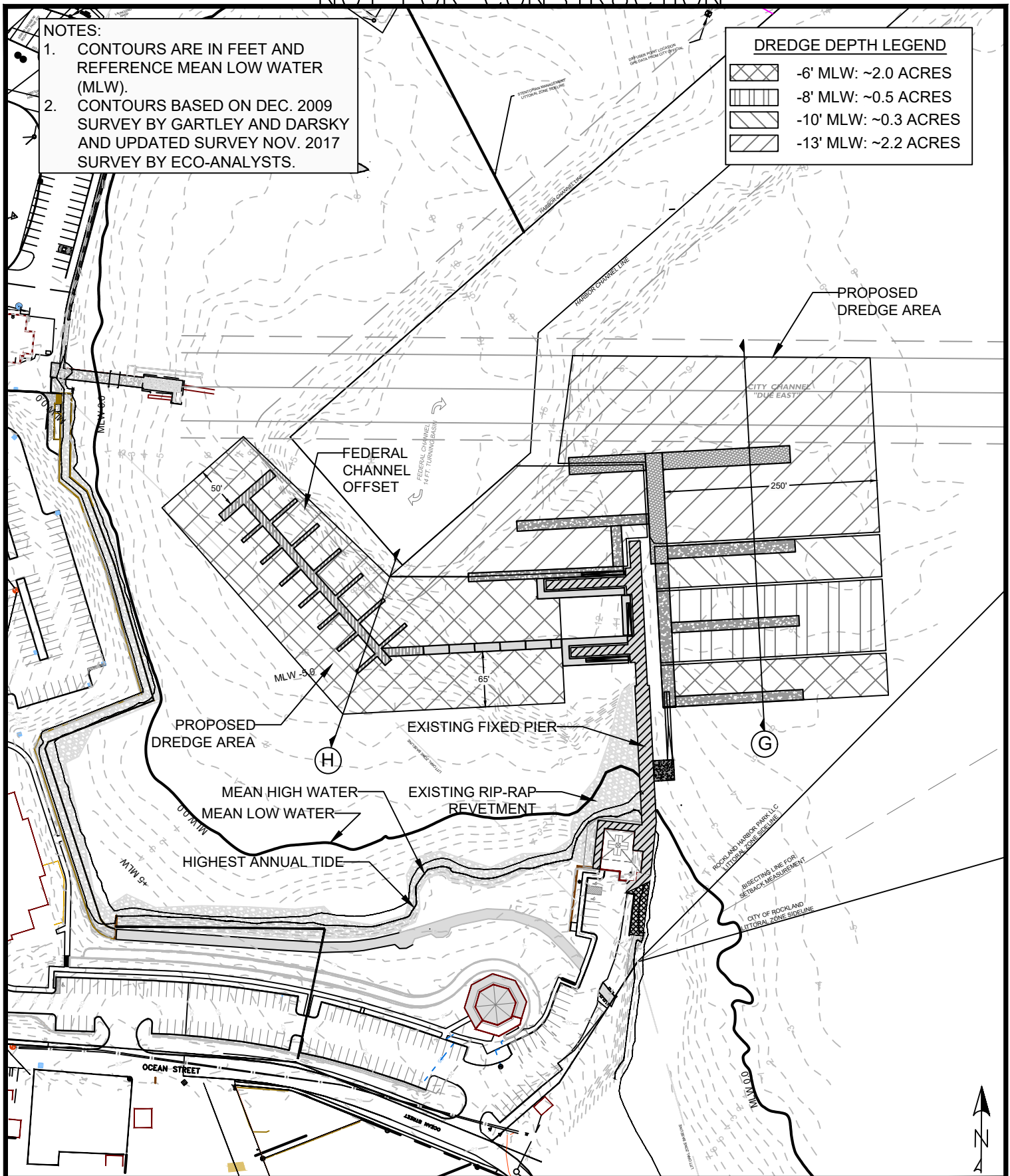

LANDMARK CORPORATION

SURVEYORS & ENGINEERS

135 Rockland Street Rockport, Maine 04856 Phone: (207) 236-6757 www.landmarkmaine.com

**SH ROCKLAND - NRPA APPLICATION
 PROPOSED DREDGE PLAN
 ROCKLAND, MAINE**

SCALE: 1"=150'

OCTOBER 2021

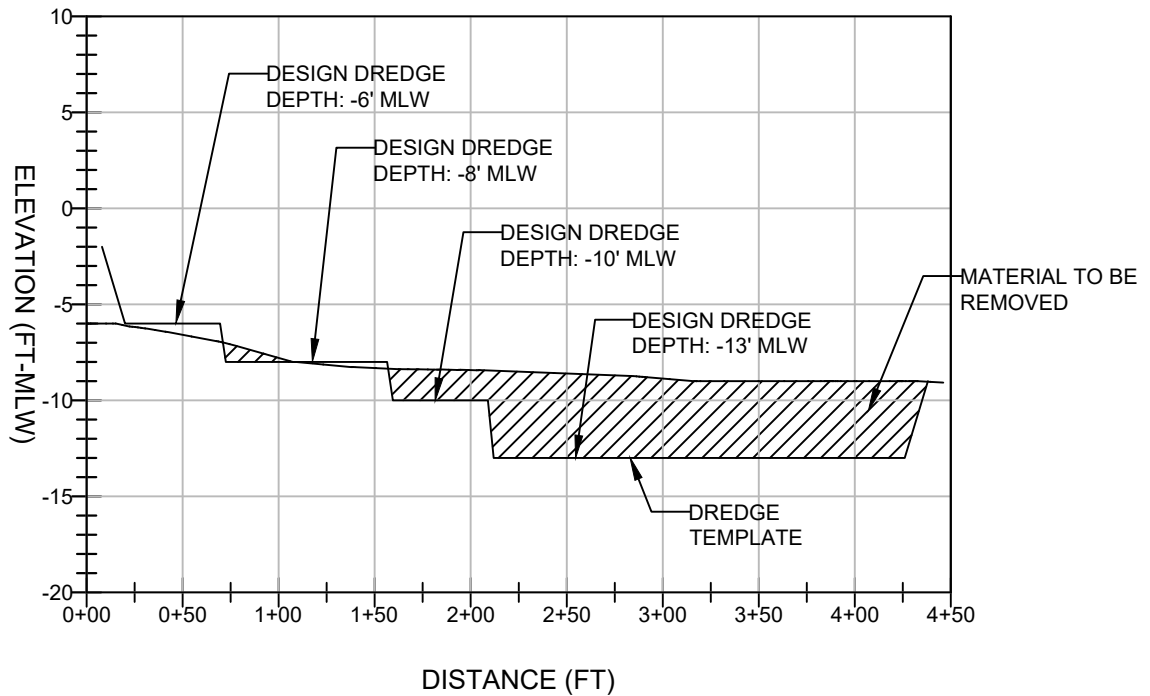

Ⓒ TYPICAL DREDGE PROFILE

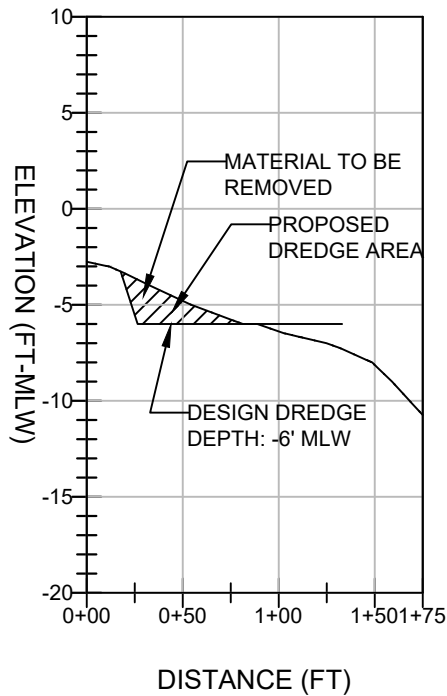

Ⓓ TYPICAL DREDGE PROFILE

- NOTES:
1. PROFILES ARE IN FEET AND REFERENCE MEAN LOW WATER (MLW).
 2. PROFILES BASED ON DEC. 2009 SURVEY BY GARTLEY AND DASKY AND UPDATED SURVEY NOV. 2017 SURVEY BY ECO-ANALYSTS.

FOR PERMITTING PURPOSES ONLY
 "NOT FOR CONSTRUCTION"

NOTES:

1. CONTOURS ARE IN FEET AND REFERENCE MEAN LOW WATER (MLW).
2. CONTOURS BASED ON DEC. 2009 SURVEY BY GARTLEY AND DASKY AND UPDATED SURVEY NOV. 2017 SURVEY BY ECO-ANALYSTS.
3. PROPOSED DREDGE CONTOURS, VOLUMES, AND AREAS ARE BASED ON CONDITIONS AT TIME OF SURVEY AND MAY VARY AT TIME OF CONSTRUCTION.

TURBIDITY CURTAIN, IF NECESSARY (LOCATION IS INDICATIVE AND SHALL BE DEPLOYED AROUND THE CURRENT AREA OF DREDGING DURING CONSTRUCTION)

FEDERAL CHANNEL OFFSET

PROPOSED -6' MLW DREDGE AREA (17,550 SF - ~450 CY)

PROPOSED CONTOURS MEAN HIGH WATER

MEAN LOW WATER
 HIGHEST ANNUAL TIDE

EXISTING FIXED PIER

EXISTING RIP-RAP REVETMENT

PROPOSED -13' MLW DREDGE AREA (91,975 SF - ~11,055 CY)

PROPOSED -10' MLW DREDGE AREA (13,120 SF - ~720 CY)

PROPOSED -8' MLW DREDGE AREA (9,540 SF - ~200 CY)

PROPOSED -6' MLW DREDGE AREA (5,750 SF - ~90 CY)

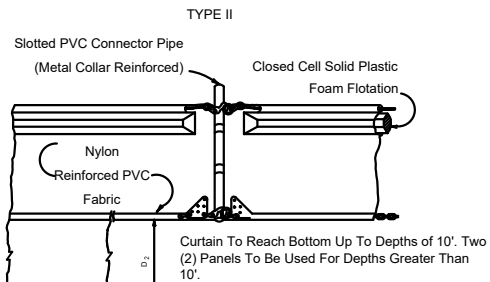

FLOATING TURBIDITY BARRIERS



LANDMARK CORPORATION

SURVEYORS & ENGINEERS

135 Rockland Street Rockport, Maine 04856 Phone: (207) 236-6757 www.landmarkmaine.com

SH ROCKLAND - NRPA APPLICATION
 TURBIDITY CONTROL NOTES AND DETAILS
 ROCKLAND, MAINE

SCALE: 1"=150'

OCTOBER 2021